

IQ HUB TABLE STAND QUICK INSTALL GUIDE

Do not use for UL2610 or EN Grade 2 or equivalent installations

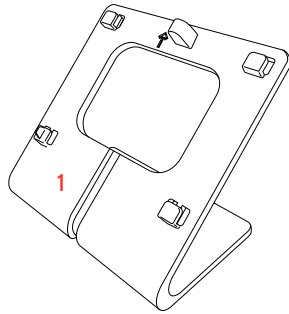

1. Locate the optional table stand.

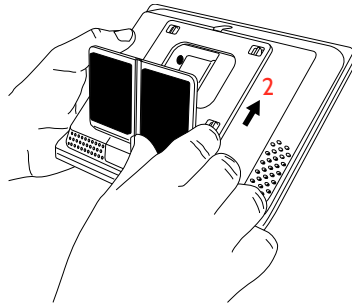

2. Position the table stand onto the back of the panel and then slide up, making sure that all 4 tabs hook into the back of the panel.

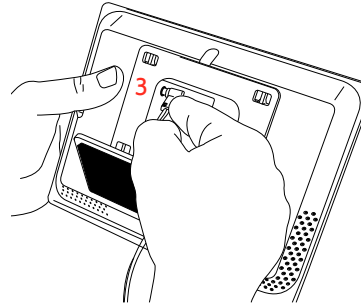

3. Insert the barrel from the power supply into the barrel jack in the back of the panel.

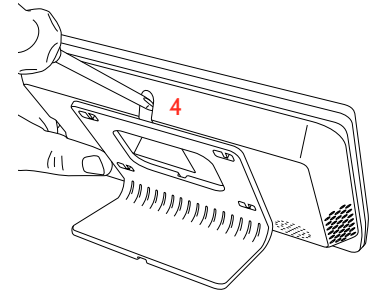

4. Secure with the top screw so that the panel cannot be removed from the table stand.